



MSTronic Co., Ltd.

2F, 12, Gongshang Rd., Wugu District, New Taipei City, 248 Taiwan

TEL:886-2-2293-0159 FAX:886-2-2292-8851

E.MAIL: mse@mse.com.tw
WEB: <http://www.mse.com.tw>

SPECIFICATION

POH-485695

DC/DC 5G PoE Injector

POH Compliant

1. INPUT :

- 1.1 Input Voltage: 40Vdc to 72Vdc Normal = 56V
- 1.2 Input Current: 2.69A at 40Vdc @ Full Load
1.93 A at 56Vdc @ Full Load
1.51 A at 72Vdc @ Full Load

2. OUTPUT :

2.1 Output Voltage & Current:

OUTPUT	56V
Max. load	1.70A
Power	95W
Min. Load	0.01A
Load reg. %	5%
Line reg. %	1%
Ripple %	1%
Noise %	1%

TOTAL POWER :95W(POH)

Note 1: Noise bandwidth is from DC to 20Mhz. Ripple & Noise is measured by Paralleling a 0.1uF metalize capacitor on the test point.

3. EFFICIENCY : 87% min at Full Load , 40Vdc ~ 72Vdc Input Voltage

4. PROTECTION

4.1 Short Circuit Protection

Output Short GND Terminal will not damage the Power Supply and will Auto-Reset.

4.2 Input with Fuse Protection.

4.3 Safety Standard: meet EN60950-1, EN62368-1

4.4 EMC: meet FCC Class B , EN55032 Class B



MSTronic Co., Ltd.

2F, 12, Gongshang Rd., Wugu District, New Taipei City, 248 Taiwan

TEL:886-2-2293-0159 FAX:886-2-2292-8851

E.MAIL: mse@mse.com.tw
WEB: <http://www.mse.com.tw>

4.5 Over Current : POH (1010mA-Class 7-8) @All DC Input F.L

4.6 Input Reverse Protection-----NO Work

4.7 INPUT LOW Voltage Protection Point : $33.2V \pm 0.3V$

4.8 OUTPUT Over Voltage Protection Point : $59V \pm 0.5V$

5. GENERAL DESCRIPTION

5.1 Operation Temperature: -40 - +70 Degree

5.2 Storage Temperature: -40 - +85 Degree

5.3 Operation Humidity: 5% - 90%

5.4 Cooling: Free air cooling

5.5 SIZE : 140*150*40 (L*W*H)m/m DIN Rail mountable

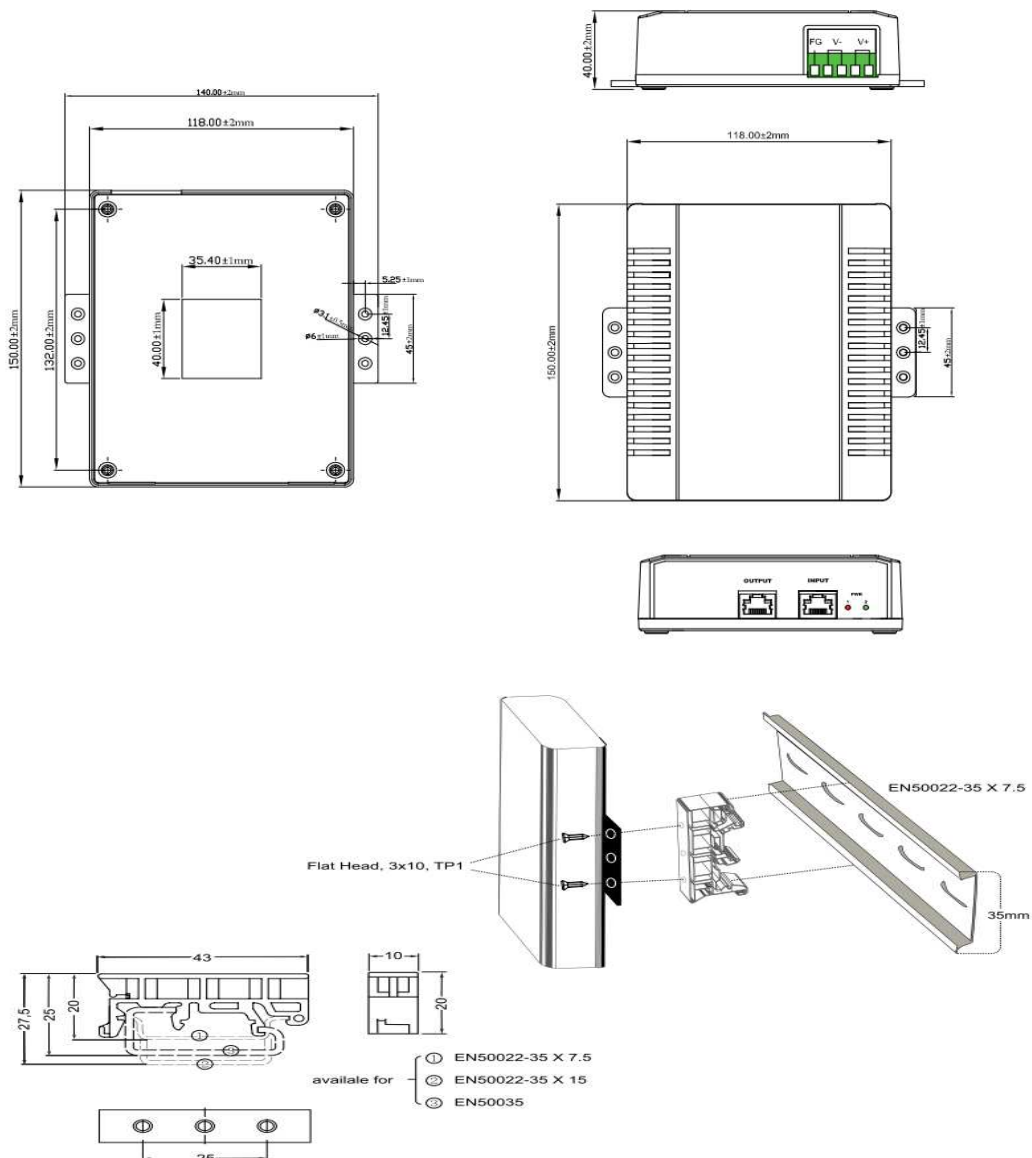



MSTronic Co., Ltd.

2F, 12, Gongshang Rd., Wugu District, New Taipei City, 248 Taiwan

TEL:886-2-2293-0159 FAX:886-2-2292-8851

E.MAIL: mse@mse.com.tw
WEB: <http://www.mse.com.tw>

6. Indication :

6.1 LED2(GREEN) Indicate POE Power is normal.

6.2 LED1(GREEN) Indicate POE Output status.

If the model is not connected to PD, the LED1 is off.

If the model is connected with a valid PD, the LED1 is ON.

If over current the LED 1 is flash.

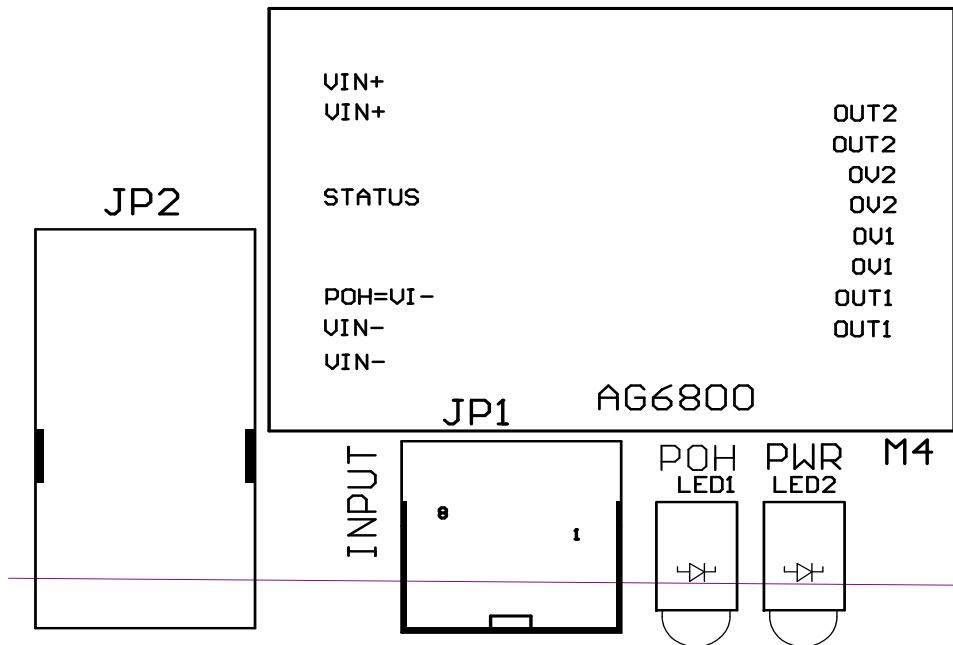



MSTronic Co., Ltd.

2F, 12, Gongshang Rd., Wugu District, New Taipei City, 248 Taiwan

TEL:886-2-2293-0159 FAX:886-2-2292-8851

E.MAIL: mse@mse.com.tw
WEB: <http://www.mse.com.tw>

7. CHANNEL CONNECTORS & PINOUT :

RJ-45 Input (Data Only)			RJ-45 Output (Data & Power)	
Pin	Symbol	Description	Symbol	Description
1	BI_DA+	Data Pair A+	-Vo + BI_DA+	power(-)+Data Pair A+
2	BI_DA-	Data Pair A-	-Vo + BI_DA-	power(-)+Data pair A-
3	BI_DB+	Data Pair B+	+Vo + BI_DB+	power(+)+Data Pair B+
4	BI_DC+	Data Pair C+	+Vo + BI_DC+	power(+)+Data Pair C+
5	BI_DC-	Data Pair C-	+Vo + BI_DC-	power(+)+Data Pair C-
6	BI_DB-	Data Pair B-	+Vo + BI_DB-	power(+)+Data Pair B-
7	BI_DD+	Data Pair D+	-Vo + BI_DD+	power(-)+Data Pair D+
8	BI_DD-	Data Pair D-	-Vo + BI_DD-	power(-)+Data Pair D-

Note :

1. the model is isolated design, the input connection instruction as below.

